



# DONKIN SOFTSEAL GATE VALVE

DUCTILE IRON, FLANGED PN16



The Series 555/401 Softseal Valve is a double-faced, resilient seat, internal screw, clear bore wedge gate valve. It is designed primarily for the isolation of natural gas and manufactured gas.

## PRODUCT DESCRIPTION

Ductile iron PN16 flanged gas gate valve designed for pressure of 7 bar MOP, temperature -10 °C to + 60 °C. Kitemarked to GIS/V7-1

## DESIGN STANDARDS

- BGE/S/V/3, EN 12266, GIS/V7 Part 1
- Face-to-face dimension according to EN 558 Table 2 Basic Series 3
- Flange Drilling according to EN1092-2

## TEST/APPROVALS

- Tested according to EN 12266.
- CE marked according to Pressure Equipment Directive
- Approved according to KITE MARK GIS/V7-1
- Made in Great Britain
- UKCA marked according to Pressure Equipment Regulations

## FEATURES

- Full double block and bleed facility with pressure relieving plug
- Soft seal positive shut off, metal to metal secondary seal
- Maintenance free
- Self supporting "flange feet" for ease of installation and stockholding
- Fasteners fully encapsulated and sealed with hot melt
- Suitable for under pressure drilling and tapping operations
- Suitable for end of line service
- Integral lifting lugs on valves 25kg+
- Stem seal replaceable under pressure
- Profiled 'O' ring body/bonnet joint
- Twin pack black epoxy coating minimum 75 microns
- Embodied carbon data available upon request
- Optional 25mm stem cap, handwheel and position indicator
- Valve installation tracker
- Stainless steel spindle



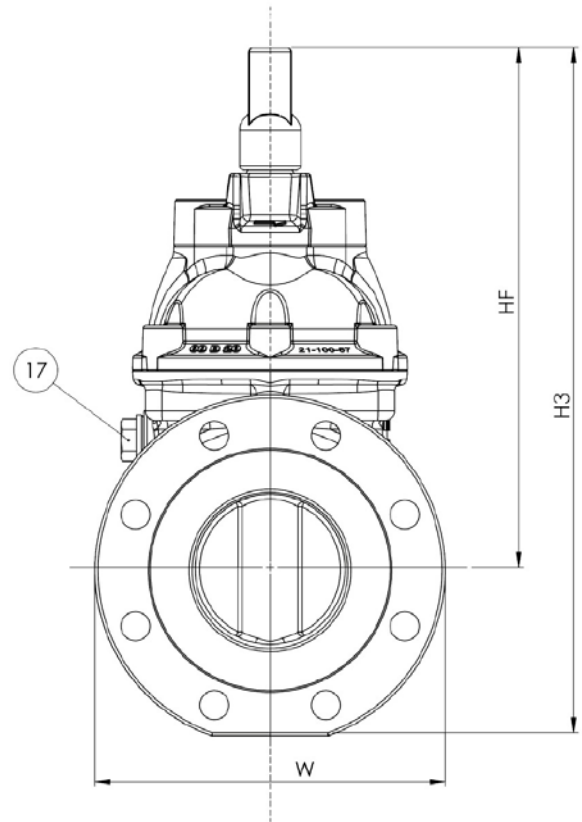
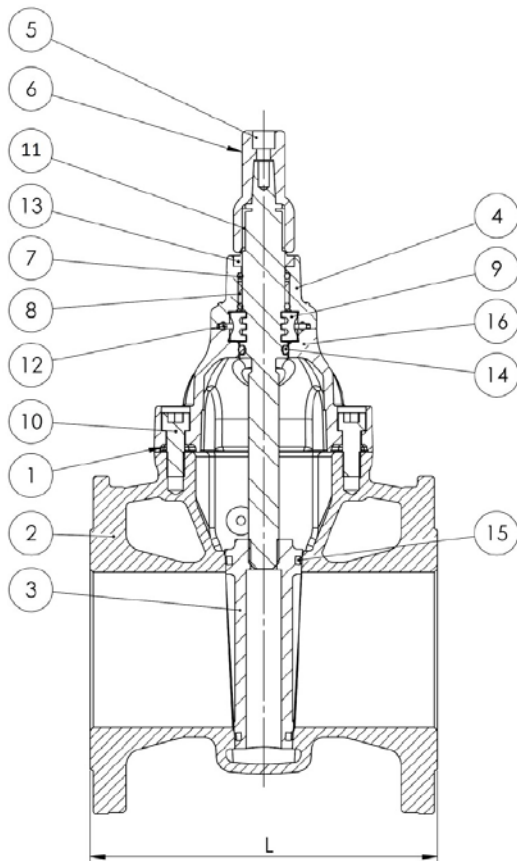

## COMPONENT LIST

1. Body-bonnet seal	NBR rubber	10. Set screw	Carbon steel
2. Body	Ductile Iron	11. Spindle	Stainless steel AISI 420
3. Wedge	Cast iron	12. Seal	NBR rubber
4. Gland	Ductile Iron	13. Wiper ring	NBR rubber
5. Screw	Carbon steel	14. Seal	NBR rubber
6. Cap	Cast iron	15. Seal	NBR rubber
7. Seal	NBR rubber	16. Bonnet	Ductile iron GJS-500-7
8. Bush	Polyamide	17. Pressure release plug	Carbon steel
9. Thrust collar	Brass		

Components may be substituted with equivalent or higher class materials without prior notification.

## REFERENCE NOS. AND DIMENSIONS

AVK ref. no.	DN mm	BR DN	H3 mm	HF mm	L mm	W mm	Turns to open	Theoretical weight/kg
555-050-04-011503	50	0.5	329	262	178	152	9	12
555-080-04-011503	80	0.5	409	319	203	190	12.5	21
555-100-04-011503	100	0.5	449	341	229	229	15.5	26
555-150-04-011503	150	0.75	564	431	267	279	14.5	45
555-200-04-011503	200	0.75	680	518	292	343	20	69
555-250-04-011503	250	0.75	880	683	330	442	24	127
555-300-04-011503	300	0.75	996	766	356	483	28	165

